

## Fire-Rated Narrow Profile Steel Doors & Frames

### Fire Rating: 60/90/120 Minutes

Fireframes® Heat Barrier Series doors and frames combined with Pilkington Pyrostop® glass, provides a barrier to radiant and conductive heat transfer. Incorporating precise European engineering, the system also allows full-lite fire doors for aesthetic or security reasons.

### FEATURES

- Fire-ratings of 60-120 minutes with required hose stream test
- Narrow steel profiles
- Full-lite doors available in single leaf or double leaf design; see Fireframes Heat Barrier Series Door fact sheet
- Modular system that can incorporate 60/90 minute full-lite temperature rise doors
- Can incorporate large individual panes of Pilkington Pyrostop® fire-resistive-rated glass, comprised of Pilkington Optiwhite™ glass and clear intumescent interlayers
- Frames supplied “K-D” (knock-down) ready for installation or welded depending on application
- Unrestricted glazing area for use in locations where total glazing exceeds 25% of wall area
- Durable steel frames ensure low maintenance system
- Door hardware available to fit functional requirements. Check with TGP for compatibility
- Finish painted at the factory to match desired color scheme
- Easy installation similar to typical storefront systems
- Passes wall assembly test standard UL 263 / ASTM E-119 for 60 and 120 minute ratings

### LISTINGS/STANDARDS

Classified and labeled by Underwriters Laboratories Inc.® and Underwriters Laboratories of Canada. File numbers R19207 (doors), R25229 (windows), R25274 (walls), design number U533 (W474 Canada). Tests performed in accordance with:

UL 9	NFPA 251	CAN/ULC-S101	ASTM E119	MEA 240-00-M
UL 10B	NFPA 252	CAN/ULC-S104		LARR 25798
UL 10C	NFPA 257	CAN/ULC-S106		
UL 263				
UL 752 (110 mm frame)				

### SPECIFICATIONS

Complete 3-part CSI format specifications are available online at [fireglass.com](http://fireglass.com), or by calling 800.426.0279.

### DOORS

DOORS: SINGLES AND AA	RATING	MAX. WIDTH	MAX. HEIGHT
Max. Door Leaf Size	60/90 min.	49-1/4" (1,251 mm)	112-7/16" (2,855 mm)
Max. Door Opening Active-Active (AA Pair)	60/90 min.	98-1/8" (2,492 mm)	112-7/16" (2,855 mm)

### FRAMING

RATING	MAX. EXPOSED GLASS AREA PER PIECE	MAX. EXPOSED GLASS DIMENSION
60 min.	7,442 in <sup>2</sup> (4.80 m <sup>2</sup> )	118-1/8" (3.00 m)
90 min.	3,724 in <sup>2</sup> (2.40 m <sup>2</sup> )	96" (2.44 m)
120 min.	3,730 in <sup>2</sup> (2.41 m <sup>2</sup> )	111" (2.81 m)

**Note:** For double egress, please reference Architectural Specification Manual at [fireglass.com/detail-drawings](http://fireglass.com/detail-drawings).

**Note:** Individual lite sizes cannot exceed “Max. Exposed Area” shown above.



BIM 3D Model Available



UL Classified & Labeled



Fire-Rated



Hose Stream Tested



Heat Barrier



Positive Pressure Tested

## DOOR DETAILS

All door hardware for Fireframes Heat Barrier Series doors is supplied by Technical Glass Products. Please contact TGP regarding your individual hardware requirements.

Standard hardware may include:

- Hinges
- Surface mounted closers
- Single mortise lock
- Panic hardware
- Tall bottom rails

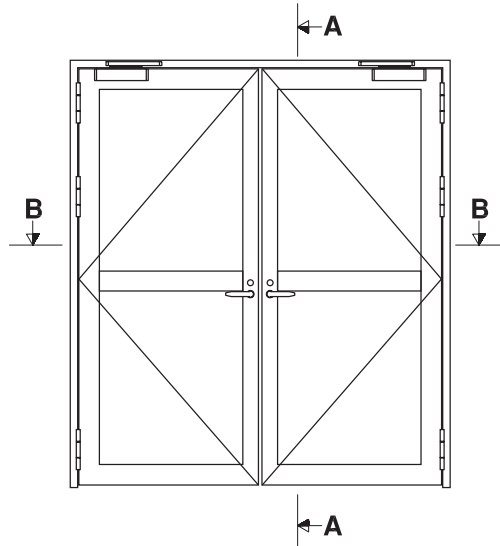

**A-A**

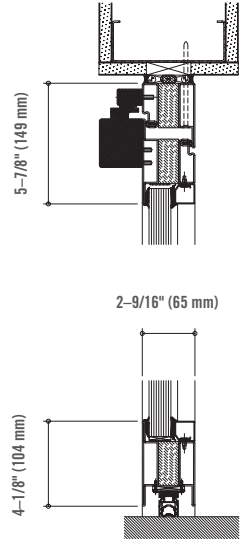

**B-B**

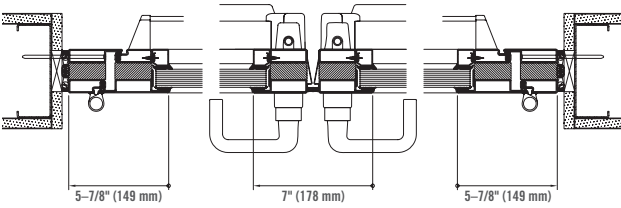

## WINDOW DETAILS

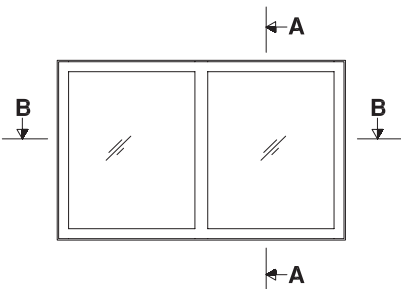

**B-B**

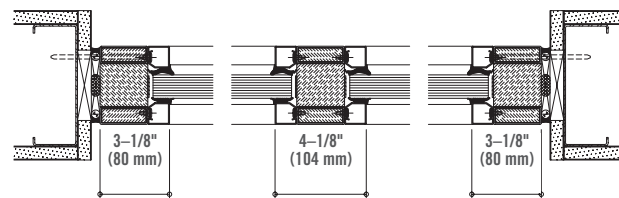

**A-A**

