



FIRE-RATED DOORS & FRAMES FOR 60/90/120 MINUTE APPLICATIONS

When combined with Pilkington Pyrostop® glass, the Fireframes® Heat Barrier Series doors and frames provide a barrier to radiant and conductive heat transfer. Incorporating precise European engineering, the system also allows full-lite fire doors for aesthetic or security reasons. Fabricated in the United States, Heat Barrier Series doors (with ratings up to 90 minutes) and frames (with ratings up to 2 hours) are listed and labeled with UL and ULC.

FEATURES

- Narrow steel profiles
- Doors available in single leaf or double leaf design
- Modular system that can incorporate 60/90 minute full-lite temperature rise doors
- Can incorporate large individual panes of Pilkington Pyrostop® glass
- Passes positive pressure test standards UL 10C, UBC 7-2, and UBC 7-4
- Frames supplied "K-D" (or welded upon request)
- Unrestricted glazing area for use in locations where total glazing exceeds 25% of wall area
- Durable steel frames ensure low maintenance system
- Hardware available to fit functional requirements. Check with TGP for compatibility
- Finish painted at the factory to match desired color scheme
- Fabricated in the U.S.A.
- Easy installation similar to typical storefront systems

LISTINGS

Listed and labeled by Underwriters Laboratories Inc.® and Underwriters Laboratories of Canada. File number for labeled 60/90/120 minute fire-rated assemblies is R-19207, design U533. Frame tests performed in accordance with ASTM E-119, CAN/ULC-S101, NFPA 251, UL 263, UL 9, UL 10C, UBC 7-2 and UBC 7-4. Door tests performed in accordance with UL 10B, UL 10C, ASTM E2074 and NFPA 252. Approved for use in New York City: MEA# 240-00-M. Approved for use in Los Angeles: LARR 25798.

SPECIFICATIONS

Complete 3-part CSI format specifications are available online at fireglass.com, or by calling **800.426.0279**.

FRAMING			DOORS		
RATING	MAX. EXPOSED GLASS AREA PER PIECE (in ²)	MAX. EXPOSED GLASS DIMENSION (in)	RATING	MAX. SINGLE DOOR LEAF SIZE (in)	MAX. EXPOSED GLASS SIZE PER PIECE (in)
60 min.	5,605	96	60 min.	48 x 96	41-5/8 x 89-3/4
90 min.	3,724	96	90 min.	48 x 96	41-5/8 x 89-3/4
120 min.	3,724	111			

Note: Individual lite sizes cannot exceed "Max. Exposed Glass Area" shown above.

DOOR DETAILS

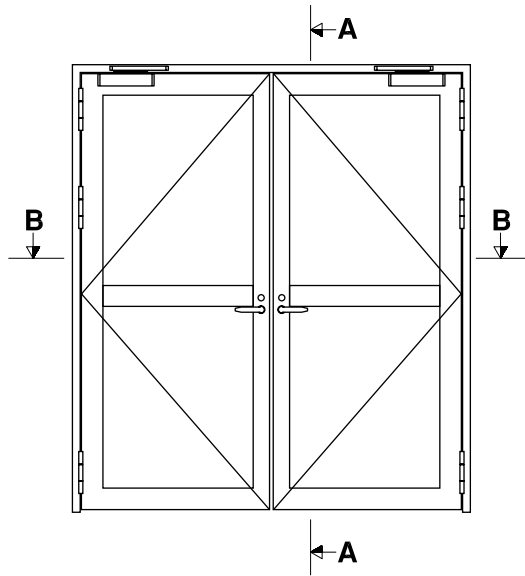

A-A

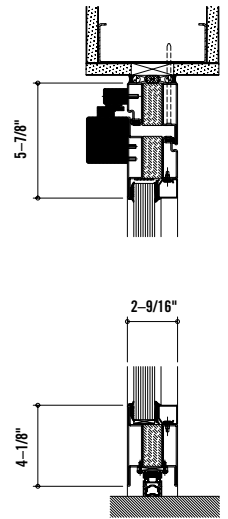

B-B

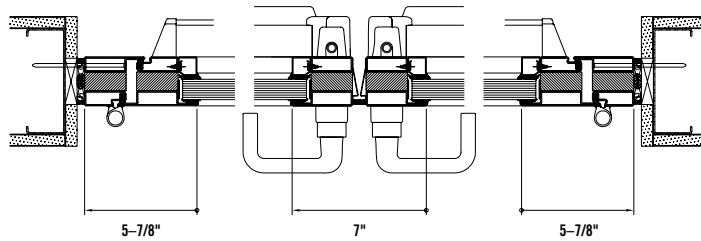

A-A

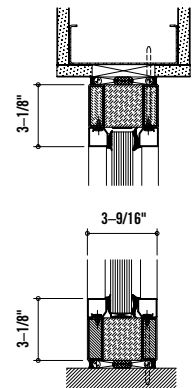
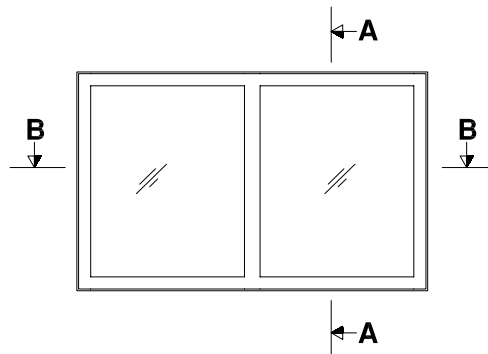

B-B

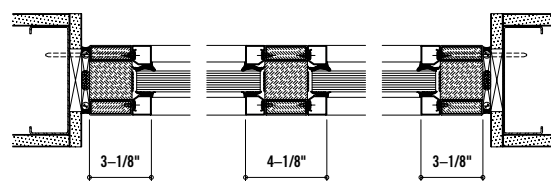

ALL DOOR HARDWARE FOR HEAT BARRIER SERIES DOORS IS SUPPLIED BY TECHNICAL GLASS PRODUCTS.

Please contact TGP regarding your individual hardware requirements.

STANDARD HARDWARE MAY INCLUDE:

- Hinges
- Surface mounted or concealed closers
- Single mortise lock
- Panic hardware
- Tall bottom rails